



家庭用

不锈钢真空保温杯

SM-SP 型

使用说明书

各部位名称

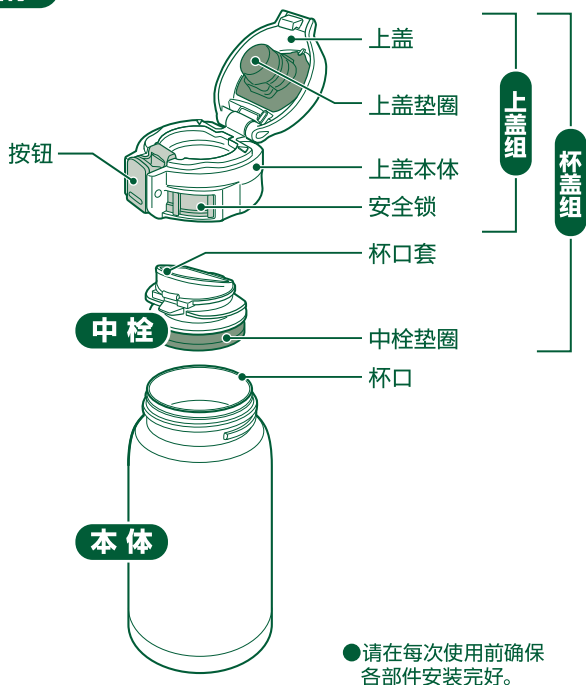

●所购商品与使用说明书上的插图可能会有不符之处。

使用前请详细阅读说明书，以便正确使用。并请妥善保管本说明书。

SM-SP (C/E) / D

务请遵守

●使用时为避免烫伤或饮料的变质、变色、商品故障或污垢，请注意下述事项。

请勿让婴幼儿使用。请勿放在婴幼儿摸得到的地方  
会造成烫伤、受伤等危险。

务必在安装了垫圈类的状态下使用  
以免外漏或烫伤，或造成脏污。

不要安装除产品专用部件以外的部件  
以免造成外漏或故障。

请勿使用保温性能不良的产品  
使用此类产品加入热饮时，本体外侧可能过热，  
会有烫伤的危险。

真空层内进水时请勿使用  
由于保温性能降低，  
会有烫伤的危险。  
另外，若其中的水分漏出，  
饮用后可能会导致身体不适。



请确实盖紧杯盖组。另外，使用后请盖紧上盖  
以免外漏或烫伤，或造成脏污。

加入饮料的量请到图的位置为止  
加入过量，盖上杯盖组时会造成溢出，  
如是热饮会有烫伤的危险。  
此外，盖紧后也会有漏出的可能。

饮料的位置

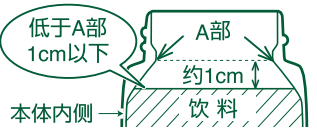

加入热水时  
●喝饮料时，勿将本体急剧倾斜，请慢慢地喝  
一旦溢出会有烫伤等危险。  
●请勿摇晃本体  
会有烫伤、受伤等危险。  
●在喝的时候有可能烫伤，请注意安全  
因隔热效应，即使加入热饮，本体外侧也会变热。  
●本体内的压力增加，杯盖组会难以取下。 此时请先打开上盖后，再取下杯盖组。  
如果强行取下杯盖组，有可能使杯盖组飞散，导致受伤或烫伤。

请勿将滚烫的茶壶接触到口  
以免倾倒造成烫伤的危险，  
或因而破损、变形。



请勿在装有杯盖组的状态下加入饮料  
以免溢出造成烫伤。

请勿靠近电暖炉或瓦斯炉等火源附近  
以免造成变形、变色。

请勿在倾斜状态或靠近脸部时打开上盖  
以免热饮突然流出或飞溅导致烫伤。

开车时请勿饮用  
以免受伤，或造成车内及衣物弄脏。

使用车内水杯架时请遵守以下注意事项

- ①使用后请确实盖紧上盖
- ②请确认本产品可以固定安放至水杯架后再使用
- ③请确认水杯架支撑强度后再使用
- ④使用市售的水杯架时，请选用固定式  
如本产品发生翻倒或倾斜、水杯架破损或  
倾倒等情况，有可能造成烫伤、受伤及事  
故。此外还可能弄脏车内与衣服。  
●根据部分车种及市售水杯架的种类不同，  
有时无法放入。

请勿手持杯盖组或上盖搬运  
一旦掉落会有危险。

请勿分解和修理  
以免造成故障或损坏等事故。

请勿使用微波炉来加热  
会有引起火花的危险。并会造成变形、变色。

请勿放在火源（煤气台等）或电炉、IH炊具、IH灶台上  
以免造成火灾或故障。



请勿放入下述的饮料

- 干冰、碳酸饮料  
产品内压力增加，造成饮料喷出或杯盖组破损飞散等，会有危险。
- 味噌汤、热汤或昆布茶等含有较多盐分的流质  
本体内侧为不锈钢材质，避免造成生锈而降低保温、保冷功能。
- 牛奶、奶类饮料、果汁等  
因成分容易变质，长时间放置不饮用，会因腐坏产生气体，导致产品内压力增加，  
造成内容物喷出或杯盖组破损飞散等危险。
- 果肉、茶叶  
会造成堵塞、外漏等。

饮料请于当天饮用完  
以免造成腐坏。另外，长时间放置不饮用，可能因内容物腐坏产生气体，使产品内部  
压力增加，导致转开时杯盖组飞散、饮料喷出或杯盖组破损飞散等危险。

本商品为饮品的保温保冷之用，请勿用于其它用途

注意事项

请确认饮料不会外漏后使用	湿度较高状态下加入冷饮，杯盖组上有时 会有水滴。放入包等里面时请直立放置。
请勿摔、碰等强力撞击 会造成树脂部分破损，本体表面凹陷或破坏或 降低保温、保冷性能。	本产品是以直接饮用为目的设计的。 倒出饮料时可能会造成飞溅。
使用后请立即充分清洗本体内侧 否则会造成生锈、穿孔等导致故障， 或引起腐坏。	放入皮包内时，请直立放置， 以免外漏。 
请绝对不要撕下本体外侧底部的贴纸 否则会造成生锈， 穿孔等导致故障。 	请勿用指甲及坚硬物品刮擦本体的图案部分 会造成图案脱落。
放入运动饮料时，即使是外出时等不便清洗的 情况下，也请使用后立即充分清洗本体内侧、 本体、本体外侧（杯口）和杯盖组。 使用后如放置不洗，会造成生锈、穿孔等故障。	长时间保温热茶时，茶水会变色。外出时建议 使用茶包。
请勿强压放入过大的冰块，请将冰块敲成 比杯口小的块状 以免变形或故障。	当摇晃本体时，会听到“沙沙”声。这是嵌在 本体内胆中用来提升保温、保冷效果的金属箔 所发出的声响，属于正常现象。
使用后请务必将中栓及垫圈类充分洗净 否则会造成腐烂、发霉、串味或变色。 另外会造成饮料外漏。	<ol style="list-style-type: none"><li>①不得存放碳酸饮料</li><li>②不得用于对乳制品或婴儿食品的长时间保温 (有细菌繁殖的危险)</li><li>③不得使用微波炉等加热设备对产品进行加热</li><li>④不得使用洗碗机清洗</li></ol>

使用方法

- 使用前请按清理方法将杯盖组、本体内侧、本体外侧充分洗净。
- 刚开始使用时，可能会有塑料等异味，随着使用次数的增加会逐渐消失。

1 从本体将杯盖组取下

将杯盖组按照箭头方向转开取下。

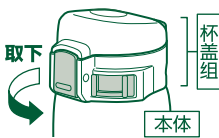

2 加入饮料

如果预先在本体内加入热水(冰水)，  
预热(预冷)1分钟左右后再加入饮料，  
就能使保温(保冷)效果更佳。

饮料的位置

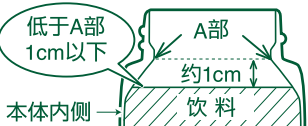

3 安装杯盖组

盖好上盖，并确认安全锁处于锁定状态※，  
然后按右图箭头方向安装杯盖组。

※锁定请参阅下图 4

- 使用前请先确认垫圈类安装正确。  
(否则有可能导致饮料外漏。)
- 请在本体直立放置的状态下确实盖紧杯盖组。

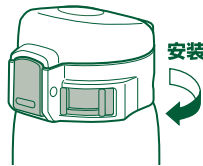

4 打开安全锁

将安全锁往右（的方向）移动，  
解除锁定。

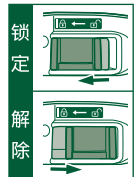
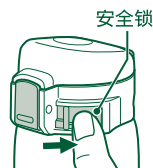

使用方法 继续

5 打开上盖

按压按钮, 然后将手指松开, 上盖便自动打开。



6 喝饮料时

- 喝饮料时, 勿将产品急剧倾斜, 请慢慢的喝。(以免溢出或烫伤, 也避免弄脏衣服。)

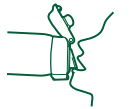

7 盖上下盖并锁定

- ① 在产品直立放置的状态下, 请确实盖紧上盖, 直到听到卡嗒声为止。
- ② 将安全锁确实移动到左端, 然后锁住。(请参阅 P.4 4 的图)



- 请勿将上盖打开放置。
- 喝完饮料后, 请将产品直立放置, 并盖紧上盖。

杯盖组的拆卸方法

1 拆卸中栓

在打开上盖的状态下, 如图所示手持杯盖组, 按杯口套后侧(▽记号所指的部分), 取下中栓。

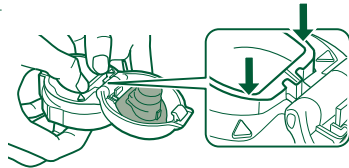

杯盖组的拆卸方法 继续

2 取下中栓垫圈

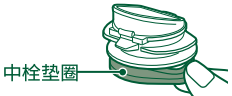

3 取下上盖垫圈

如图所示捏住上盖垫圈的顶部取下。



杯盖组的安装方法

- 请正确安装上盖组、上盖垫圈、中栓、中栓垫圈。(以免操作不良导致饮料外漏)

1 安装上盖垫圈

使上盖垫圈的缺口部与上盖的突起部对齐, 安装上盖垫圈。

- 请务必在安装了上盖垫圈后使用。

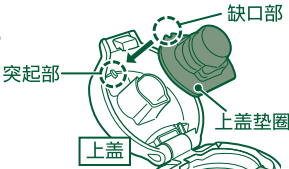

2 安装中栓垫圈

将中栓垫圈的凹部对准中栓的凸部, 以从周围按压的方式安装。

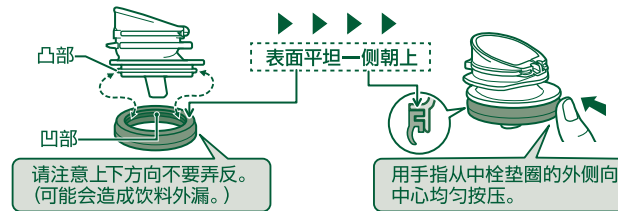

杯盖组的安装方法 继续

3 安装中栓

把上盖组的凹部与中栓的凸部对准后, 从下向上推至深处, 确保已切实安装。

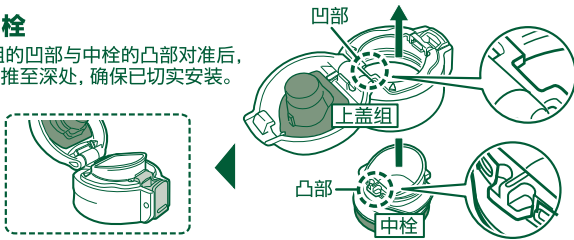

清理

- 为防止产生异味, 污垢附着和发霉, 一直长保清洁使用, 请使用后务必清理。
- 请务必拆卸后清理。(请参照P.5、6)

本体

- ① 用海绵沾上温水稀释的洗碗专用洗涤剂清洗。
  - ② 冲洗后请充分干燥, 不留水分。
- 本体内侧请使用带手柄的软质海绵刷等清洗, 以免损伤防粘涂层。

杯盖组

- ① 用海绵沾上温水稀释的洗碗专用洗涤剂清洗。
  - ② 冲洗后请用干数次。不留水分, 并将水分擦净后, 充分晾干。
- 请将杯盖组拆卸后再洗净、擦干。
  - 难以清洗的部份请使用市售的小刷子等清洗。

- 使用上述方法也无法除去本体涂层部分因摩擦而产生的条纹状污垢时, 可使用柔软的橡皮擦去此类污垢。

清理须知

- 请勿煮沸。请勿使用烘碗机、餐具干燥机等。
- 请勿使用信那水、去污粉、含研磨材质的洗涤剂、炊帚(尼龙制、金属制等)、密胺海绵、海绵的尼龙面等清洗。以免损伤本产品。
- 请勿使用含氯的漂白剂。另外, 即使非含氯的漂白剂也可能导致本体的图案、印刷或贴纸脱落, 因此请勿在清理本体外侧时使用漂白剂。
- 可整体清洗, 请勿长时间放置于水中。
- 长时间不使用时, 请用温水或冷水充分清洗, 完全晾干后放在远离高温和高湿度的场所存放。以免损伤本产品。

若有红色锈斑或水垢时的清理方法

使用过程中由于水质、异物等, 可能导致本体内侧出现红色锈斑或水垢。此种状况出现时, 请在热水中加入约10%的醋, 并将其倒入本体内, 不要安装杯盖组, 放置30分钟~1小时, 之后再再将本体内侧充分洗净。

清理 继续

茶垢等的清理方法

建议使用“象印不锈钢保温瓶清洗剂SB-ZA01E”清洗不锈钢保温杯本体内侧、杯盖水垢或茶垢。(另售)清洗本体时请卸下杯盖组。具体事宜请咨询当地经销店。  
● 请注意清洗本體時不可蓋上瓶蓋組。

- 杯盖组属于消耗品。建议一年更换一次为宜。
- 本品采用了安全可靠且符合食品卫生安全要求的材料, 但是, 为了保证最佳性能, 有部件受损时请及时更换。更换部件时, 请预先记录型号和部件名称, 然后联系您购买的经销商或象印客服中心。(需自费)

品质标示

品名: 不锈钢真空保温杯

型号	容量 (L)	重量 (kg)	保温效力(℃)		保冷效力(℃)
			1小时	6小时	6小时
SM-SP24 SM-SP24E	0.24	0.15	≥85	≥61	≤9

保温/保冷效力是商品在直立放置下, 于室温20±2℃时, 加入水量如 P.2 饮料的位置图中所示高度的热开水后, 其水温降至95±1℃开始经过1小时及6小时之后; 或加入水量如 P.2 饮料的位置图中所示高度的冷开水后, 其水温升至4±1℃开始经过6小时之后, 所测得瓶内的温水或冷水水温。

材料“食品接触用”:  
本体内侧 奥氏体型不锈钢06Cr19Ni10(SUS304) (防粘涂层)  
本体外侧 奥氏体型不锈钢06Cr19Ni10(SUS304) (压克力树脂涂层)  
杯口 奥氏体型不锈钢06Cr19Ni10 (SUS304)  
上盖 聚丙烯 中栓 聚丙烯 垫圈 硅胶  
与食品接触部分的其他材料符合相应国家标准的规定  
执行标准: GB/T 29606-2013 不锈钢真空杯 (合格品)  
上海象印家用电器有限公司  
联系地址: 中国(上海)自由贸易试验区富特北路225号第三层D13部位(邮编:200131)  
制 造 商: 象印有限公司  
制造商地址: 日本国大阪市北区天满1丁目20番5号  
原 产 地: 泰国  
象印公司全国服务热线 : 800-819-9119  
手机用户拨打 : 400-680-9119  
公司主页 : <http://zsjrushi-china.com>



Household Use Only

## STAINLESS MUG Model SM-SP Instruction Manual

### Name of Each Part

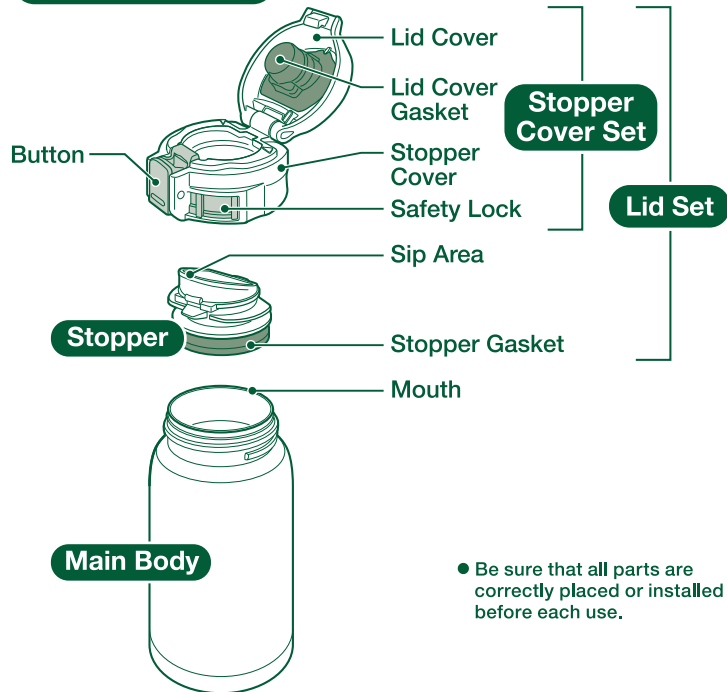

●The illustrations used in this instruction manual may differ from the actual product you have purchased.

Please read these instructions before use, and keep for future reference.

### Important Safeguards

● Please follow these instructions to prevent scalding, deterioration and discoloration of beverages, as well as malfunction and staining of the Mug.

**Do not allow infants or small children to use this product. Keep out of the reach of infants and small children.**

Mishandling may cause injury or scalding.

**Always make sure that the Gaskets are attached during use.**

Contents may leak and cause scalding or stains.

**Do not attach parts other than those specifically designed for this product.**

Doing so may cause leaks or breakage.

**Do not use if the Mug loses its heat retention properties.**

The outside of the Mug may become very hot if hot beverages are poured inside.

**Do not use if water enters the interior of the Vacuum Layer.**

In this case, the heat-retaining performance may deteriorate, resulting in a risk of burns. In addition, if the internal water seeps out, drinking it may cause illness.



**Be sure to set the Lid Set and close the Lid Cover securely after use.**

Contents may leak and cause scalding or stains.

**Leave 1cm (1/2-inch) room on top when filling the Main Body.**

Contents may overflow when placing the Lid Set.

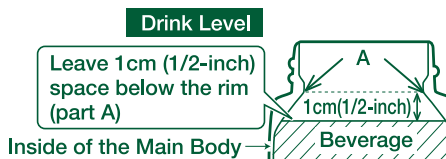

**When containing hot beverages:**

- **Drink slowly without tilting the Mug suddenly.**  
There is a possibility that the beverage may spill and cause burns.
- **Do not shake the Mug.**  
Doing so may cause scalds or injury.
- **Be careful not to scald yourself when drinking out of the Mug.**  
Due to its vacuum insulation, the outside of the Mug will not become hot, while the beverages inside will remain very hot for many hours. Please drink with caution.
- **The pressure inside the Mug may rise, making it difficult to remove the Lid Set. If that happens, open the Lid Cover once, and remove the Lid Set.**  
Forcibly removing the Lid Set may make it fly off abruptly, causing injuries or burns.

**Do not allow hot kettles to touch the Mouth of the Main Body.**

The Main Body may tip over, causing scalds.



**Do not fill with beverages while the Lid Set is attached.**

Doing so may cause beverages to overflow and may cause burning and scalding.

**Do not place near heat sources such as gas stoves, ovens and heaters.**

Doing so may cause deformation or discoloration of the Mug.

**Do not open the Lid Cover with the Mug close to your face or tilted toward you.**

Hot beverages may suddenly come out or spew out and may cause scalding.

**Do not drink out of the Mug while driving.**

Doing so may cause scalds or stain the interior of the car or clothes.

**When using a vehicle drink holder:**

- ① **Always keep the Lid Cover securely closed when not drinking.**
- ② **Make sure that the product can remain stable inside the drink holder before using it.**
- ③ **Check the strength of the drink holder before use.**
- ④ **Do not use a hanging-type drink holder that attaches to the window or air vent.**

If the product falls or tips over, or the drink holder falls off or becomes damaged, this may cause scalding, injuries, or accidents. In addition, the interior of the car or your clothes may become stained.

- **The Mug may not fit into some drink holders.**

**Do not hold the Mug by the Lid Set or the Lid Cover when carrying.**

The Mug may fall and cause injuries.

**Do not disassemble the Main Body.**

Doing so may cause injury or damage the Mug.

**Do not heat in a microwave.**

Doing so may cause sparks, deformation or discoloration of the Mug.

**Do not place near open flames (from gas stoves, etc.), on top of electric heaters or IH hot plates, or other IH cooking devices.**

Doing so may cause a fire or malfunction.

**Do not fill the Mug with the following:**

- **Dry ice and carbonated drinks:** Contents may spill out or the pressure may cause the Lid Set to burst, causing injuries.
- **Liquids high in sodium such as soup and Kobu-cha:** Although the liner is made of 18/8 stainless steel and is nonstick coated, salt may cause rust resulting in loss of thermal insulation.
- **Dairy products and fruit juice:** If left inside for a long period of time, contents may spoil and produce gas that may cause the Lid Set to burst, causing injuries.
- **Fruit pulp and tea leaves:** May become caught on the Stopper Gasket and cause contents to spoil.

**Consume beverages within the same day.**

Not doing so may cause spoiling. In addition, if left inside for a long period of time, spoiled beverages may produce gas, raising the pressure inside the Mug and causing the Lid Set to burst or beverages to spill, resulting in injuries and scalding.

**This Mug is for storing and keeping beverages hot or cold. Please do not use for other than intended purposes.**

### Warnings & Cautions

SM-SP (C/E) / D

**Make sure that there is no beverage leakage before using the Mug.**

**Avoid dropping or hitting against hard surfaces.**

Damage to the plastic or stainless steel surface of the Mug may reduce its ability to retain heat.

**Clean the Main Body after every use.**

Not cleaning thoroughly may cause the Main Body to rust, beverages to spoil, or cause pinholes.

**Do not remove the sticker on the bottom of the Main Body.**

Doing so may cause rust or holes.



**When you fill the Mug with sports drinks, even in situations where you are unable to clean the Mug properly, such as during an outing, always thoroughly rinse the inside and outside (Mouth) of the Main Body and the Lid Set immediately after consumption.**

Leaving the Mug as is after consumption may cause rust, holes or other problems.

**Do not force large ice cubes in. Break them into smaller pieces instead.**

Doing so may cause deformation or damage to the product.

**Always clean the Stopper and Gaskets thoroughly after use.**

Not doing so may cause decay, mold, odor or discoloration. It may also cause leaks.

**If a cold beverage is put into the product under highly humid conditions, condensation may form on the Lid Set. Stand the product upright when placing it in bags.**

**This product is designed to be drunk from directly. If it is used for pouring, the beverage may splash.**

**Store the Mug upright when carrying inside bags to prevent beverages from spilling.**



**Do not scratch or rub the design on the outside of the Main Body strongly using fingernails or hard objects.**

This may cause the design to come off.

**Hot tea may discolor if stored for a long period of time. We recommend the use of tea bags and brewing right before consumption.**

**The rattling noise that may be heard when the Main Body is shaken comes from the metallic foil used in the vacuum insulation to increase heat (cold) retention, and does not indicate a malfunction.**



## How to Use:

- Follow the instructions for care and wash the Lid Set, the inside and outside of the Main Body thoroughly before use.
- When you first use the product, there may be a plastic smell. However, this will become less noticeable with use.

### 1 Remove the Lid Set from the Main Body.

Remove the Lid Set from the Main Body by turning it counterclockwise as illustrated.

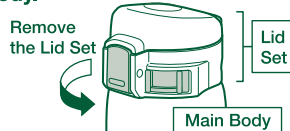

### 2 Fill the Mug with beverage.

For better heat retention, preheat or precool the Main Body with hot water (cold water) for about one minute, and then fill it with your beverage.

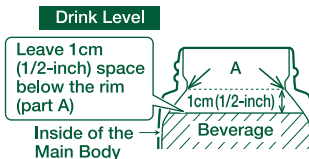

### 3 Set the Lid Set securely.

Close the Lid Cover, lock the Safety Lock\* then turn the Lid Set clockwise as illustrated to set.

\* See illustration 4 below.

- Confirm that the Gaskets are correctly attached before using.  
(If not correctly attached, the beverage may leak.)
- Firmly close the Lid Set with the Main Body in an upright position.



### 4 Unlock the Safety Lock.

Slide the Safety Lock to the right ( ) to unlock.



### 5 Open the Lid Cover.

Push the Button and release to open the Lid Cover.



### 6 Drink the beverage.

- Do not tilt the Mug suddenly when drinking.  
(The beverage may spill and cause scalding or stain clothes.)



### 7 Close the Lid Cover and lock.

- With the Mug at an upright position, close the Lid Cover until it clicks.
  - Slide the Safety Lock all the way to the left to lock (see p.5 illustration 4).
- Do not leave the Mug with the Lid Cover open.
  - Always close the Lid Cover securely at an upright position.



## How to Disassemble the Lid Set:

### 1 Remove the Stopper.

With the Lid Cover open, hold the Lid Set as illustrated, and press on the back of the Sip Area (parts indicated by the ▽ marks) to remove the Stopper.

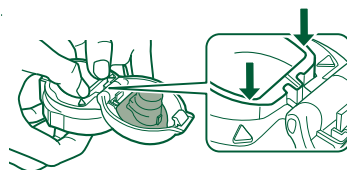

### 2 Remove the Stopper Gasket.



## How to Disassemble the Lid Set: continued

### 3 Remove the Lid Cover Gasket.

Pinch the edge of the Lid Cover Gasket as illustrated and pull it toward you to remove.



## How to Assemble the Lid Set:

- Be sure to attach the Stopper Cover Set, Lid Cover Gasket, Stopper and Stopper Gasket correctly to prevent malfunction or leaking of beverages.

### 1 Attach the Lid Cover Gasket.

Align the Small Opening on the Lid Cover Gasket with the protrusion on the Lid Cover and press to attach.

- Be sure to set the Lid Cover Gasket before use.

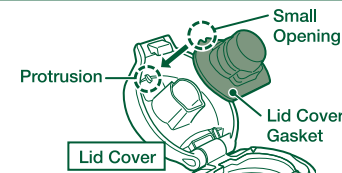

### 2 Attach the Stopper Gasket.

Line up the recess in the Stopper Gasket with the ridge on the Stopper, and, applying pressure from the outside in, push it into place.

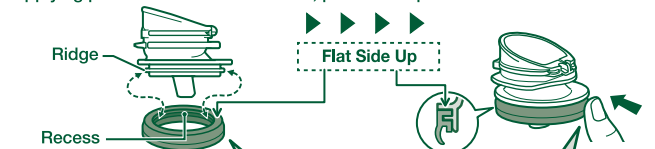

### 3 Attach the Stopper.

Align the opening of the Stopper Cover Set and the tab of the Stopper, and press the Stopper in to attach securely.

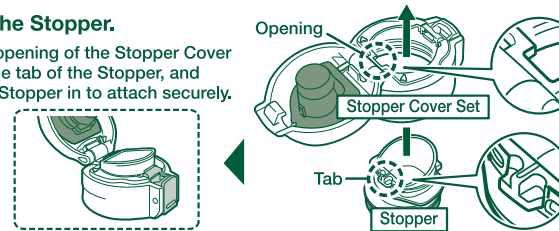

## How to Take Care of Your Mug:

- Clean the product after each use to prevent odors and mold, and to keep the product sanitary.
- Always disassemble the product before cleaning. (see p.6-7)

### Main Body

- Wash with warm water and mild dishwashing liquid using a soft sponge.
  - Rinse and then dry so there is no water left inside.
- To avoid damaging the nonstick coating, wash the liner of the Main Body using a soft sponge with a handle or a similar implement.

### Lid Set

- Wash with warm water and mild dishwashing liquid using a soft sponge.
  - Rinse and then shake a few times to ensure there is no water left inside. Wipe thoroughly dry.
- When washing the Lid Set, disassemble it first then wash and dry.
  - Use a small brush sold in stores if necessary.

- Streaks or smudges caused by rubbing on the coated portion of the Main Body can be removed using a soft eraser.

### When Cleaning Your Product:

- Do not use a dishwasher or dish-dryer. Do not boil to sanitize.
- Do not clean using paint thinner, polishing powders, abrasive cleansers, scrub brushes (nylon, metal wire, etc.), melamine sponges, the nylon side of an abrasive sponge, or any similar items. High temperatures and humidity may damage the product.
- Do not use chlorine-based bleach. In addition, do not use any kind of bleach, even non-chlorine-based, to clean the outside of the Main Body. It may damage the paint, print, or stickers on the Main Body.
- Do not soak in water for an extended period of time.
- If the product is not going to be used for an extended period, wash thoroughly with cold or lukewarm water and dry well. Store the product away from high temperatures and humidity. High temperatures and humidity may damage the product.

### To Remove Rust Spots and Water Stains:

You may find rust spots or water stains caused by impurities in the water. To remove these stains, fill the Main Body with hot water with 10% vinegar and let it stand for 30 minutes to an hour without attaching the Lid Set, then wash the interior thoroughly.

### To Remove Coffee and Tea Stains:

To remove coffee and tea stains from the interior and the Lid Set, we recommend using Zojirushi's cleaning detergent SB-ZA01E. Always remove the Lid Set when using SB-ZA01E. Contact Zojirushi Customer Service or your local dealer for further information.

### Replacing the Stopper and Gaskets:

We take care in only using materials that are safe and hygienic for food contact. However, if plastic parts become damaged or its surface becomes rough, please replace them for optimum performance. The Stopper and other consumable parts may need to be replaced due to time and wear. Please check them about once a year. When replacing parts, please record the model number and part name beforehand. Then contact either the store where you purchased the product or Zojirushi Customer Service. Replacement parts may be available for an additional charge.