



Household Use Only

STAINLESS MUG

Model **SM-SZ/
SM-SS/SM-SXE**

Instruction Manual

Name of Each Part

Lid Set

Stopper Cover Set

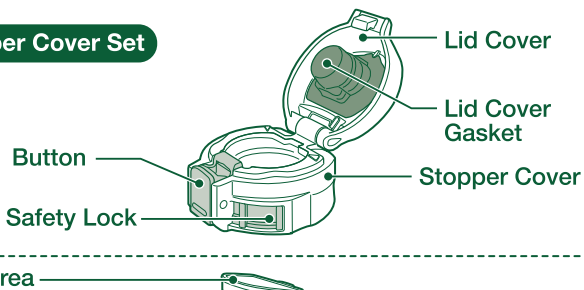

Stopper

Stopper Gasket

Main Body

- Be sure that all parts are correctly placed or installed before each use.

● The illustrations used in this instruction manual may differ from the actual product you have purchased.

Important Safeguards

- Please follow these instructions to prevent scalding, deterioration and discoloration of beverages, as well as malfunction and staining of the Mug.

Do not allow infants or small children to use this product. Keep out of the reach of infants and small children.
Mishandling may cause injury or scalding.

Always make sure that the Lid Cover Gasket and Stopper Gasket are attached during use.

Contents may leak and cause scalding or stains.

Do not fill with beverages while the Lid Set is attached.

Doing so may cause beverages to overflow and may cause burning and scalding.

Be sure to set the Lid Set and close the Lid Cover securely after use.

Contents may leak and cause scalding or stains.

Do not use if the Mug loses its heat retention properties.

The outside of the Mug may become very hot if hot beverages are poured inside.

Do not open the Lid Cover with the Mug close to your face or tilted toward you.

Hot beverages may suddenly come out or spew out and may cause scalding.

Do not heat in a microwave.

Doing so may cause sparks, deformation or discoloration of the Mug.

Do not drink out of the Mug while driving.

Doing so may cause scalds or stain the interior of the car or clothes.

When containing hot beverages:

- **Drink slowly without tilting the Mug suddenly.**

There is a possibility that the beverage may spill and cause burns.

- **Do not shake the Mug.**

Doing so may cause scalds or injury.

- **Be careful not to scald yourself when drinking out of the Mug.**

Due to its vacuum insulation, the outside of the Mug will not become hot, while the beverages inside will remain very hot for many hours. Please drink with caution.

- **The pressure inside the Mug may rise, making it difficult to remove the Lid Set. If that happens, open the Lid Cover once, and remove the Lid Set.**

Forcibly removing the Lid Set may make it fly off abruptly, causing injuries or burns.

Do not fill the Mug with the following:

- **Dry ice and carbonated drinks:** Contents may spill out or the pressure may cause the Lid Set to burst, causing injuries.

- **Liquids high in sodium such as soup and Kōbu-cha:** Although the liner is made of 18/8 stainless steel and is nonstick coated, salt may cause rust resulting in loss of thermal insulation.

- **Dairy products and fruit juice:** If left inside for a long period of time, contents may spoil and produce gas that may cause the Lid Set to burst, causing injuries.

- **Fruit pulp and tea leaves:** May become caught on the Stopper Gasket and cause contents to spoil.

SM-SZ / SM-SS / SM-SXE (C/E) / B

Do not disassemble the Main Body.

Consume beverages within the same day.

Not doing so may cause spoiling. In addition, if left inside for a long period of time, spoiled beverages may produce gas, raising the pressure inside the Mug and causing the Lid Set to burst or beverages to spill, resulting in injuries and scalding.

Do not place near heat sources such as gas stoves, ovens and heaters.

Doing so may cause deformation or discoloration of the Mug.

Do not remove the sticker on the bottom of the Main Body.

Doing so may cause rust or holes.



Leave 1cm (1/2-inch) room on top when filling the Main Body.

Contents may overflow when placing the Lid Set.

Drink Level

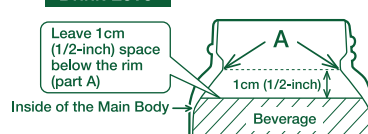

When using a vehicle cup holder accessory:

- ① **Always keep the Lid Cover securely closed when not drinking.**
Beverage may spill if the Mug is tipped over, causing scalds or injury.
 - ② **Make sure the Mug fits into the holder securely before placing it in.**
Do not use the Mug if it does not fit into the holder securely as it may tip over and cause scalds, injury or accidents.
 - ③ **Check that the strength of the cup holder is sufficient to hold the Mug before using.**
The Mug may fall and cause injuries or burns, or stain the interior of the car or clothes if the cup holder does not hold up.
 - ④ **Do not use a hanging-type cup holder that attaches to the window or air vent.**
The cup holder may fall off.
- **The Mug may not fit into some cup holders.**

When filling the Mug with sports drinks:

- In order to prevent rusting and/or pinholes, rinse the inside and outside of the Main Body and the Lid Set immediately after consumption.
- Clean the inside using a soft sponge to protect the nonstick coating from getting scratched.

Do not place near open flames (from gas stoves, etc.), on top of electric heaters or IH hot plates, or other IH cooking devices.

Doing so may cause a fire or malfunction.

Please read these instructions before use, and keep for future reference.

Important Safeguards continued

Clean the Main Body after every use.

Not cleaning thoroughly may cause the Main Body to rust, beverages to spoil, or cause pinholes.

This Mug is for storing and keeping beverages hot or cold.

Please do not use for other than intended purposes.

Warnings & Cautions

Do not allow hot kettles to touch the Mouth of the Main Body.

The Main Body may tip over, causing scalds.



Avoid dropping or hitting against hard surfaces.

Damage to the plastic or stainless steel surface of the Mug may reduce its ability to retain heat.

Hot tea may discolor if stored for a long period of time. We recommend the use of tea bags and brewing right before consumption.

Do not scratch or rub the design on the outside of the Main Body strongly using fingernails or hard objects.

This may cause the design to come off.

Placing ice cubes in the Mug may cause the internal pressure to decrease and the Lid Cover Gasket may come off when opening the Lid Cover. If this happens, please reattach the Lid Cover Gasket.

The rattling noise that may be heard when the Main Body is shaken comes from the copper or aluminum foil in the vacuum insulation to increase heat (cold) retention and does not indicate a malfunction.

This product is designed to be drunk from directly. If it is used for pouring, the beverage may splash.

Do not force large ice cubes in. Break them into smaller pieces instead.

Doing so may cause deformation or damage to the product.

Do not hold the Mug by the Lid Set or the Lid Cover when carrying.

The Mug may fall and cause injuries.

Always clean the Stopper, Lid Cover Gasket and Stopper Gasket thoroughly after use.

Not doing so may cause decay, mold, odor or discoloration. It may also cause leaks.

Do not attach parts other than those specifically designed for this product.

Doing so may cause leaks or breakage.

If a cold beverage is put into the product under highly humid conditions, condensation may form on the Lid Set. Stand the product upright when placing it in bags.

How to Use:

- Follow the instructions for care and wash the Lid Set, the inside and outside of the Main Body thoroughly before use.
- When you first use the product, there may be a plastic smell. However, this will become less noticeable with use.

1 Remove the Lid Set from the Main Body.

Remove the Lid Set from the Main Body by turning it counterclockwise as illustrated.

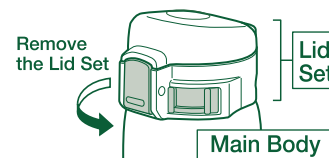

2 Fill the Main Body with beverage.

Drink Level

Leave 1cm (1/2-inch) space below the rim (part A)

For better heat retention, preheat or precool the Main Body with hot water (cold water) for about one minute, and then fill it with your beverage.

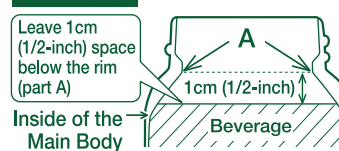

3 Set the Lid Set securely.

Close the Lid Cover, lock the Safety Lock* then turn the Lid Set clockwise as illustrated to set.

*See illustration 4 below.

- Confirm that the Stopper Gasket and Lid Cover Gasket are correctly attached before using. (If not correctly attached, the beverage may leak.)
- Firmly attach the Lid Set to the upright Main Body, lining up the Zojirushi logo mark with the front of the Lid Set.
- Attach the Lid Set properly and turn the Mug upside down to make sure contents do not leak.

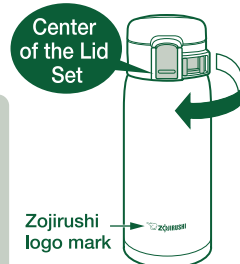

4 Unlock the Safety Lock.

Slide the Safety Lock to the right (LOCK) to unlock.

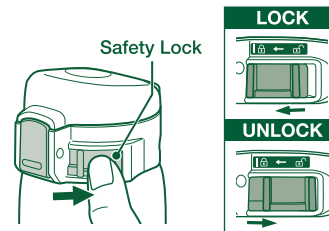

5 Open the Lid Cover.

Push the Button and release to open the Lid Cover.

The Lid Cover may open slightly.

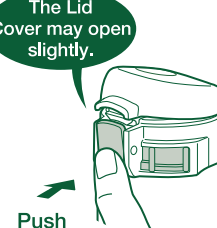

Opens

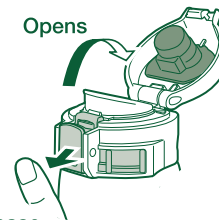

6 Drink the beverage.

- Do not tilt the Mug suddenly when drinking. (The beverage may spill and cause scalding or stain clothes.)

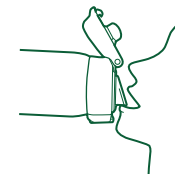

7 Close the Lid Cover and lock.

- ① With the Mug at an upright position, close the Lid Cover until it clicks.
- ② Slide the Safety Lock to the left to lock (see pg.5 illustration 4).

Close securely until it clicks.



- Do not leave the Mug with the Lid Cover open.
- Always close the Lid Cover securely at an upright position.

- Store the Mug upright when carrying inside bags to prevent beverages from spilling.



How to Disassemble & Assemble the Lid Set:

- Be sure to attach the Stopper Cover Set, Lid Cover Gasket, Stopper and Stopper Gasket correctly to prevent malfunction or leaking of beverages.

How to Disassemble:

1 Remove the Lid Set from the Main Body.

2 Remove the Stopper.

With the Lid Cover open, hold the Lid Set as illustrated, and press on the back of the Sip Area (parts indicated by the ▽ marks) to remove the Stopper.

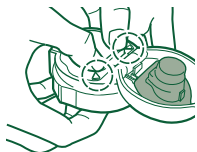

3 Remove the Stopper Gasket.

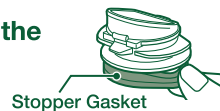

4 Remove the Lid Cover Gasket.

Pinch the edge of the Lid Cover Gasket as illustrated and pull it toward you to remove.



How to Assemble:

1 Attach the Stopper Gasket.

Line up the recess in the Stopper Gasket with the ridge on the Stopper, and, applying pressure from the outside in, push it into place.

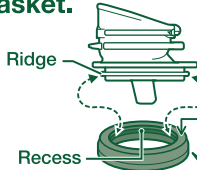

Be careful with the top and the bottom of the gasket and be sure to set correctly. Not doing so may cause beverages to leak.

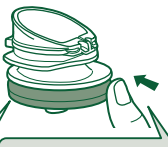

2 Attach the Lid Cover Gasket.

Align the Small Opening on the Lid Cover Gasket with the protrusion on the Lid Cover and press to attach.

- Be sure to set the Lid Cover Gasket before use.

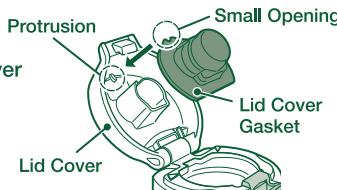

3 Attach the Stopper.

Align the opening of the Lid Cover Set and the tab of the Stopper, and press the Stopper in to attach securely.

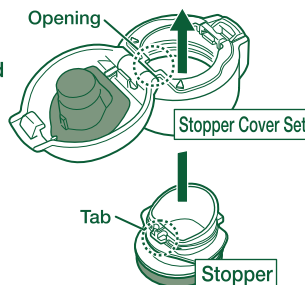
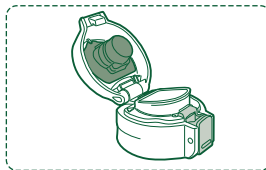

How to Take Care of Your Mug:

- Clean the product after each use to prevent odors and mold, and to keep the product sanitary.

- Always disassemble the product before cleaning. (see pg.7)

Exterior Lid Set

- Wash with warm water and mild dishwashing liquid using a soft sponge.
- Rinse, shake a few times and wipe dry.
 - When washing the Lid Set, disassemble it first then wash and dry.
 - Use a small brush sold in stores if necessary.

Interior

- Wash with warm water and mild dishwashing liquid using a soft sponge with handle.
- Then rinse and wipe moisture out to dry.

When Cleaning Your Product:

To protect the paint, print or stickers on the outside of the Main Body:

- Do not use a dishwasher or dish-dryer. Do not boil to sanitize.
- Do not use bleach on the outside of the Main Body.

- Do not clean using paint thinner, metal wire scrub brushes, scrubbing brushes that include abrasive cleaners, polishing powders, cleansers, melamine sponges, or any similar items.
- Do not use chlorine type bleach.
- Do not soak in water for an extended period of time.
- Wipe moisture off thoroughly to prevent water stains or rusting.
- If the product is not going to be used for an extended period, wash thoroughly with cold or lukewarm water and dry well. Store the product away from high temperatures and humidity. High temperatures and humidity may damage the product.

How to Take Care of Your Mug: continued

To Remove Rust Spots and Water Stains:

You may find rust spots or water stains caused by impurities in the water. To remove these stains, fill the Main Body with hot water with 10% vinegar and let it stand for 30 minutes to an hour without attaching the Lid Set, then wash the interior thoroughly.

To Remove Coffee and Tea Stains:

To remove coffee and tea stains from the interior and the Lid Set, we recommend using Zojirushi's cleaning detergent SB-ZA01E. Always remove the Lid Set when using SB-ZA01E. Contact Zojirushi Customer Service or your local dealer for further information.

Replacing the Lid Cover Gasket, Stopper and Stopper Gasket:

We take care in only using materials that are safe and hygienic for food contact. However, if plastic parts become damaged or its surface becomes rough, please replace them for optimum performance. The Stopper and other consumable parts may need to be replaced due to time and wear. Please check them about once a year. When replacing parts, please record the model number and part name beforehand. Then contact either the store where you purchased the product or Zojirushi Customer Service. Replacement parts may be available for an additional charge.

SPECIFICATIONS:

Product: STAINLESS MUG

Model No.	Capacity	Weight	Heat Retention (Above)	Cold Retention (Below)
SM-SZ36 SM-SXE36	0.36 liter (12 oz.)	0.17 kg (6 oz.)	86°C (187°F) @ 1 hr. / 67°C (153°F) @ 6 hrs.	9°C (48°F) @ 6 hrs.
SM-SZ48 SM-SS48C SM-SS48F SM-SS48G SM-SS48S SM-SXE48	0.48 liter (16 oz.)	0.205 kg (8 oz.)	87°C (189°F) @ 1 hr. / 71°C (160°F) @ 6 hrs.	8°C (46°F) @ 6 hrs.

Heat/Cold Retention Testing Conditions:

At a room temperature of 20°C±2°C (68°F±4°F), the Main Body is filled with hot or cold water up to the level illustrated in **Drink Level** on p. 3, and left standing in an upright position. For heat retention, once the hot water reaches 95°C±1°C (203°F±2°F), the temperature is measured after 1 hour and 6 hours.

For cold retention, once the cold water reaches 4°C±1°C (39°F±2°F), the temperature is measured after 6 hours.

Materials:	Inner Liner	Stainless Steel (Nonstick Coated)
Exterior		Stainless Steel (Acrylic Resin Painted)
Mouth		Stainless Steel
Stopper		Polypropylene
Lid Cover		Polypropylene
Gasket		Silicone

Manufacturer: Zojirushi Corporation

Address: 1-20-5 Tenma, Kita-ku, Osaka 530-8511, Japan

不锈钢真空保温杯

SM-SZ/SM-SS/
SM-SXE型

使用说明书

各部位名称

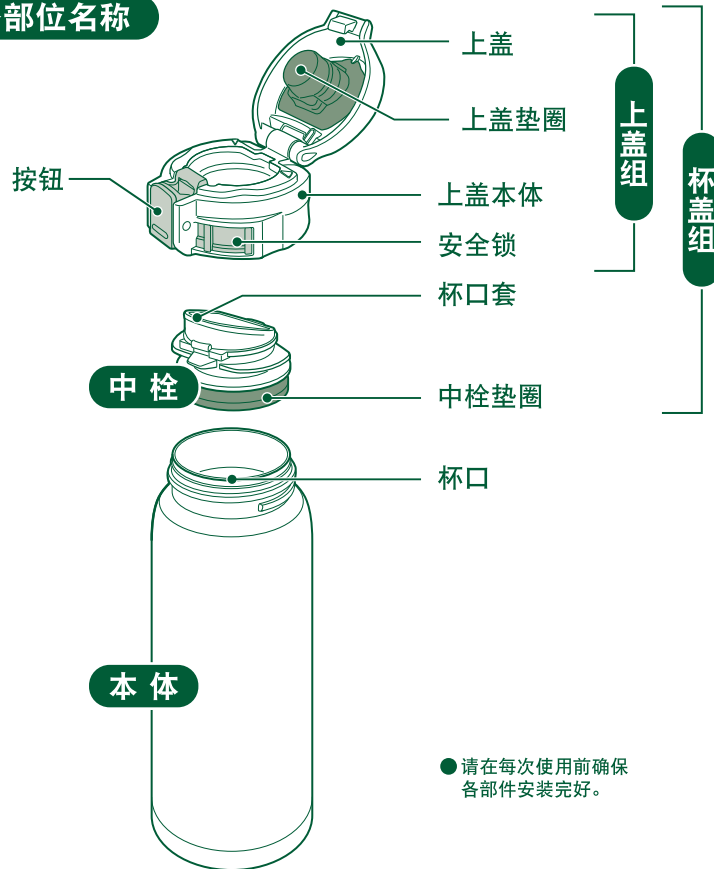

●所购商品与使用说明书上的插图可能会有不符之处。

使用前请详细阅读说明书，以便正确使用。并请妥善保管本说明书。

SM-SZ / SM-SS / SM-SXE (C/E) / B

务请遵守

●使用时为避免烫伤或饮料的变质、变色、商品故障或污垢，请注意下述事项。

请勿让婴幼儿使用。请勿放在婴幼儿摸得到的地方 会造成烫伤、受伤等危险。	请勿使用保温性能不良的产品 使用此类产品加入热饮时，本体外侧可能过热，会有烫伤的危险。
务必在安装了上盖垫圈、中栓垫圈的状态下使用 以免外漏或烫伤，或造成脏污。	请勿在倾斜状态或靠近脸部时打开上盖 以免热饮突然流出或飞溅导致烫伤。
请勿在装有杯盖组的状态下加入饮料 以免溢出造成烫伤。	请勿使用微波炉来加热 会有引起火花危险。并会造成变形、变色。
请确实盖紧杯盖组。另外，使用后请盖紧上盖 以免外漏或烫伤，或造成脏污。	开车时请勿饮用 以免烫伤，或造成车内及衣物弄脏。

加入热水时

- 喝饮料时，勿将本体急剧倾斜，请慢慢地喝
一旦溢出会有烫伤等危险。
- 请勿摇晃本体
会有烫伤、受伤等危险。
- 在喝的时候有可能烫伤，请注意安全
因隔热效应，即使加入热饮，本体外侧也不会变热。
- 本体内的压力增加，杯盖组会难以取下。
此时请先打开上盖后，再取下杯盖组。
如果强行取下杯盖组，有可能使杯盖组飞散，导致受伤或烫伤。

请勿放入下述的饮料

- 干冰、碳酸饮料
本体内压力增加，造成饮料喷出或杯盖组破损飞散等，会有危险。
- 味噌汤、热汤或昆布茶等含有较多盐分的流质
本体内侧为不锈钢材质，避免造成生锈而降低保温、保冷功能。
- 牛奶、奶类饮料、果汁等
因成分容易变质，长时间放置不饮用，会因腐败产生气体，导致本体内压力增加，造成内容物喷出或杯盖组破损飞散等危险。
- 果肉、茶叶
会造成堵塞、外漏等。

请勿分解和修理 以免造成故障或损坏等事故。	请勿靠近电暖炉或瓦斯炉等火源附近 以免造成变形、变色。
饮料请于当天喝完 以免造成腐坏。另外，长时间放置不饮用，可能因内容物腐坏产生气体，使本体内压力增加，导致转开时杯盖组飞散、饮料喷出或杯盖组破损飞散等危险。	请绝对对不要撕下本体外侧底部的贴纸 否则会造成生锈，穿孔等导致故障。 

加入饮料的量请到图的位置为止

加入过量，盖上杯盖组时会造成溢出，如是热饮会有烫伤的危险。
此外，盖紧后也会有漏出的可能。

饮料的位置



使用车内的置杯架时...

- ①使用后请确实盖紧上盖
以免本体翻倒或倾斜时，导致饮料外漏造成烫伤及受伤。
 - ②请确认本体已完全放入置杯架后再使用
在不稳定或未确实放入的状态下使用，一旦本体倾倒等会造成烫伤、受伤及事故。
 - ③请确认支撑强度后再使用
若置杯架支撑强度不够，会造成置杯架破损或倾倒烫伤，并会弄脏车内与衣服。
 - ④使用市售的置杯架时，请选购固定式
请勿使用吊挂于窗边或冷气孔等吊挂式置杯架，以免置杯架倾倒。
- 根据部分车种及市售置杯架的种类不同，有时无法放入。

放入运动饮料时，请务必遵守以下事项

- 即使是外出时等不便清洗的情况下，也请使用后立即清洗本体内侧、本体外侧、杯盖组。
使用后如放置不洗，会造成生锈、穿孔等故障。
- 为避免刮伤本体内侧的防粘涂层，请使用柔软的海绵进行清洗。
如果刮伤会造成生锈、穿孔等故障。

请勿放在火源（煤气台等）或电炉、IH炊具、IH灶台上

以免造成火灾或故障。

杯盖组的拆卸·安装方法

●请正确安装上盖组、上盖垫圈、中栓、中栓垫圈。（以免操作不良导致饮料外漏）

拆卸方法

1 从本体将杯盖组取下

2 拆卸中栓

在打开上盖的状态下, 如图所示手持杯盖组, 按杯口套后侧(▽记号所指的部分), 取下中栓。

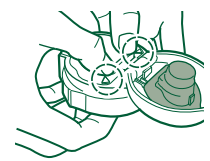

安装方法

1 安装中栓垫圈

将中栓垫圈的凹部对准中栓的凸部, 以从周围按压的方式安装。

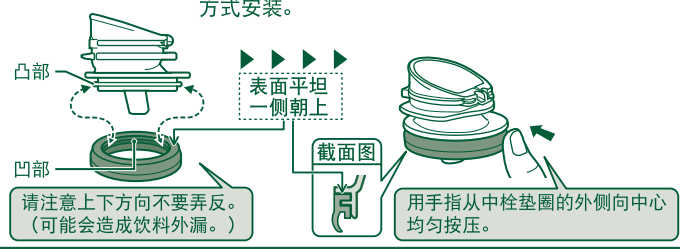

2 安装上盖垫圈

使上盖垫圈的缺口部与上盖的突起部对齐, 安装上盖垫圈。

●请务必在安装了上盖垫圈后使用。

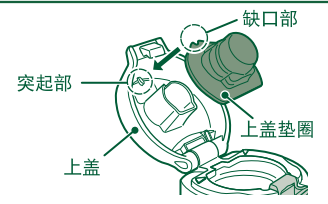

3 安装中栓

把上盖组的凹部与中栓的凸部对准后, 从下向上推至深处, 确保已切实安装。

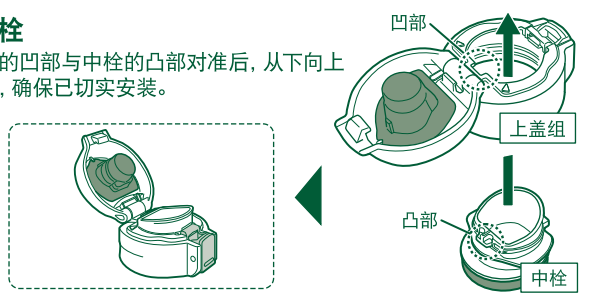

清理

●为防止产生异味, 污垢附着和发霉, 一直长保清洁使用, 请使用后务必清理。

●请务必拆卸后清理。（请参照P.7）

本体外侧 杯盖组

- ①用海绵沾上温水稀释的洗碗专用洗涤剂清洗。
- ②冲洗后请甩几次, 并将水分充分擦净后晾干。
- 请将杯盖组拆卸后再洗净、擦干。
- 难以清洗的部份请使用市售的小刷子等清洗。

本体内侧

- ①请使用有手柄的软质海绵刷等沾上温水稀释的洗碗专用洗涤剂清洗。
- ②冲洗后擦净水分并晾干。

清理须知

- 请勿煮沸。请勿使用烘碗机、餐具干燥机等。
- 本体外侧请勿使用漂白剂。
- 可能会造成本体的图案、印刷或贴纸脱落。
- 请勿使用信那水、金属钢丝球、含研磨材质的海绵刷、去污粉、洗洁剂、密胺海绵等清洗。
- 请勿使用含氯的漂白剂。
- 可整体清洗, 请勿长时间放置于水中。
- 整体清洗本体后, 请务必擦干水分。
- 以免留下水迹及生锈。
- 长时间不使用时, 请用温水或冷水充分清洗, 完全晾干后放在远离高温和高湿度的场所存放。
- 以免损伤本产品。

清理 继续

若有红色锈斑或水垢时的清理方法

使用过程中由于水质、异物等, 可能导致本体内侧出现红色锈斑或水垢。此种状况出现时, 请在热水中加入约10%的醋, 并将其倒入本体内, 不要安装杯盖组, 放置30分钟~1小时, 之后再再将本体内侧充分洗净。

茶垢等的清理方法

建议使用“象印不锈钢保温瓶清洗剂SB-ZA01E”清洗不锈钢保温杯本体内侧、杯盖组的水垢或茶垢、咖啡垢等。（另售品）
●使用清洗剂清洗本体时请卸下杯盖组。

- 上盖垫圈、中栓、中栓垫圈属于消耗品。建议一年更换一次为宜。
- 本品采用了安全可靠且符合食品卫生安全要求的材料, 但是, 为了保证最佳性能, 有部件受损时请及时更换。更换部件时, 请预先记录型号和部件名称, 然后联系您购买的经销商或象印客服中心。（需自费）

品质标示

品名: 不锈钢真空保温杯					
型号	容量 (L)	重量 (kg)	保温效力 (°C)		保冷效力 (°C)
			1小时	6小时	6小时
SM-SZ36 SM-SXE36	0.36	0.17	≥86	≥67	≤9
SM-SZ48 SM-SS48C SM-SS48F SM-SS48G SM-SS48S SM-SXE48	0.48	0.205	≥87	≥71	≤8

保温/保冷效力是商品在直立放置下, 于室温20±2°C时, 加入水量如P.3 **饮料的位置** 图中所示高度的热开水后, 其水温降至95±1°C开始经过1小时及6小时之后; 或加入水量如P.3 **饮料的位置** 图中所示高度的冷开水后, 其水温升至4±1°C开始经过6小时之后, 所测得瓶内的温水或冷水水温。

材料“食品接触用”:
本体内侧 奥氏体型不锈钢06Cr19Ni10 (SUS304) (防粘涂层)
本体外侧 奥氏体型不锈钢06Cr19Ni10 (SUS304) (压克力树脂涂层)
杯口 奥氏体型不锈钢06Cr19Ni10 (SUS304)
上盖 聚丙烯 中栓 聚丙烯 垫圈 硅胶
与食品接触部分的其他材料符合相应国家标准的规定
执行标准: GB/T 29606-2013 不锈钢真空杯 (合格品)
上海象印家用电器有限公司
联系地址 : 中国 (上海) 自由贸易试验区富特北路225号第三层D13部位 (邮编: 200131)
制 造 商 : 象印有限公司
制造商地址 : 日本国大阪市北区天满1丁目20番5号
原 产 地 : 泰国
象印公司全国服务热线 : 800-819-9119
手机用户拨打 : 400-680-9119
公司主页 : <http://zozirushi-china.com>